

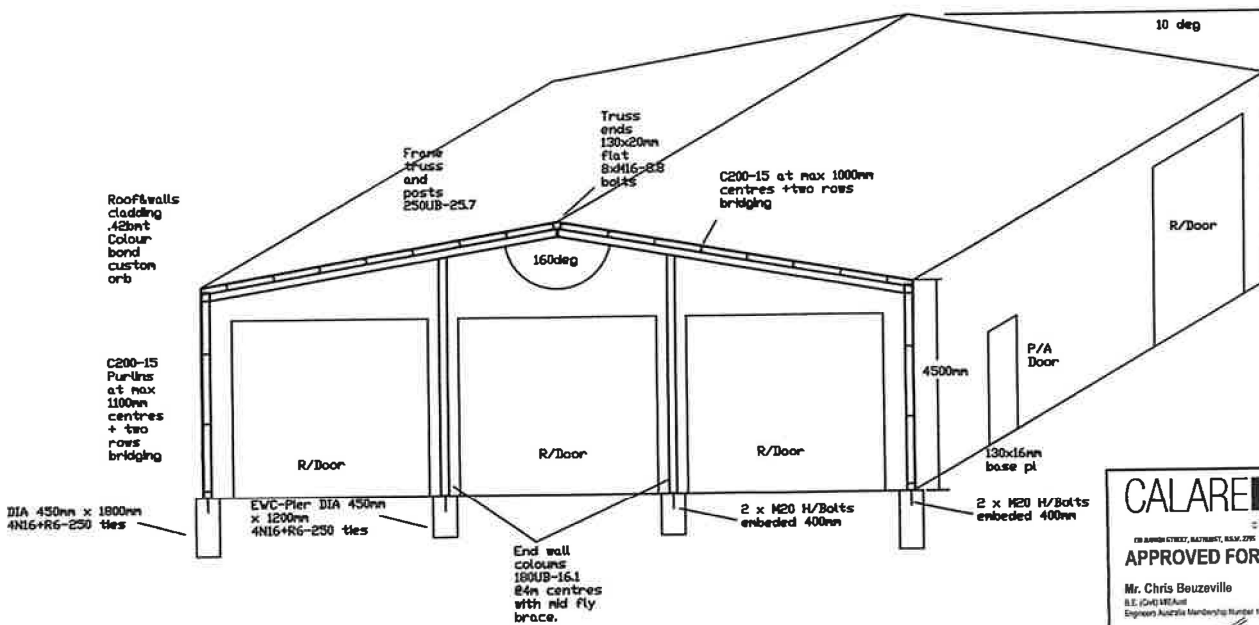

Google Earth

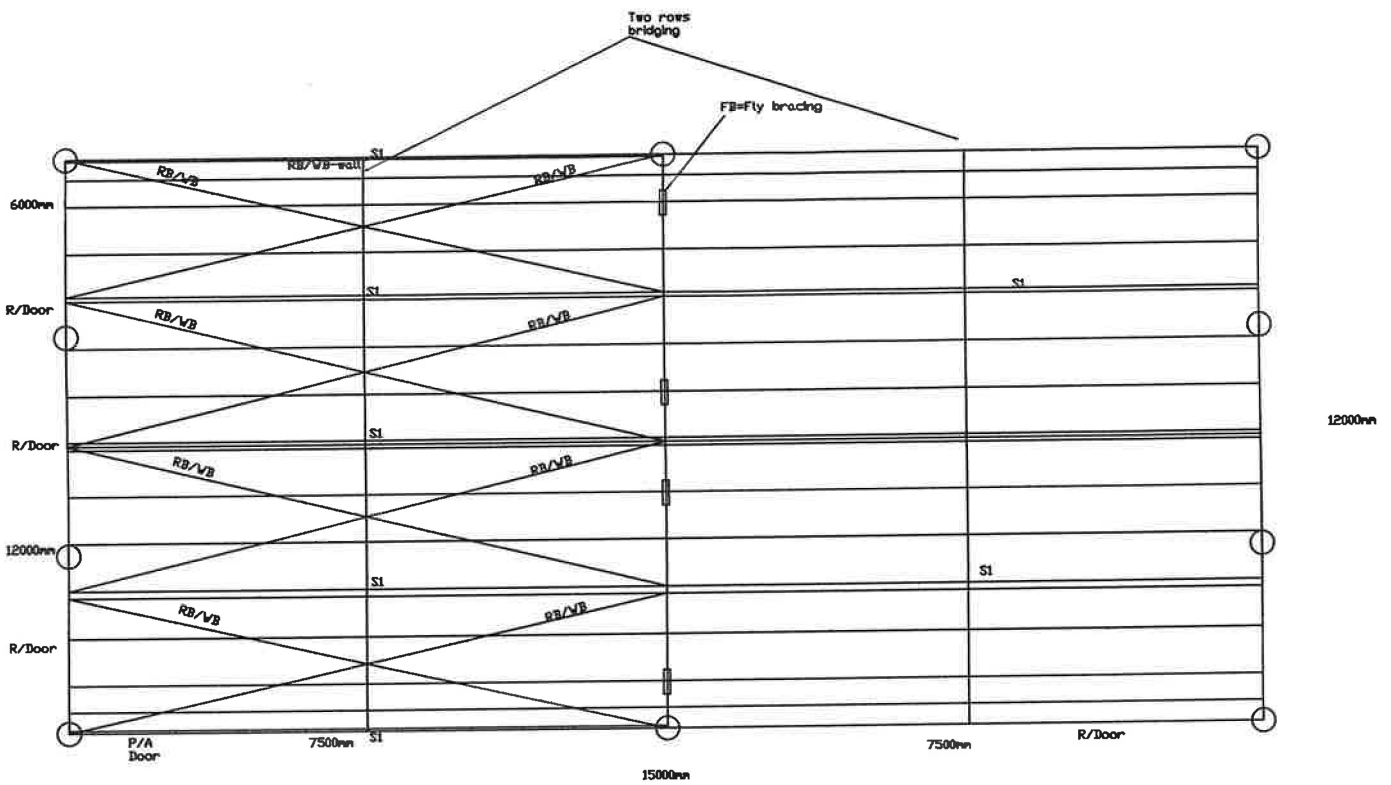

CALARE CIVIL
CONSULTING ENGINEERS
18/08/2010/17/22, 16/7/2017, 01/11/2018 Tel: 083 6202193 Fax: 083 6202193
APPROVED FOR CONSTRUCTION
Mr. Chris Beuzeville
B.E., Civil Engineer
Engineer Assoc2016 Membership Number 1001081 (Structural College) and RPEQ 06586
Signature: _____ Date: 11/04/2024
Please refer to the attached letter dated 11/04/2024

PSP 12M X 15M X 4.5M SHED fully enclosed with 4 x roller doors	S1=100 x 3 SHS, Qty 5
CLINET- Forbye Sutherland 30 Holt ST Lake Cargelligo NSW	RB/VB= DIA16-rod tensioned, Qty 8
DNP LEVEL @ 33.18'S ALT=160 440KN REG AD TC=2.0	FB= EA 30 x 3, Qty 8